

Springmill

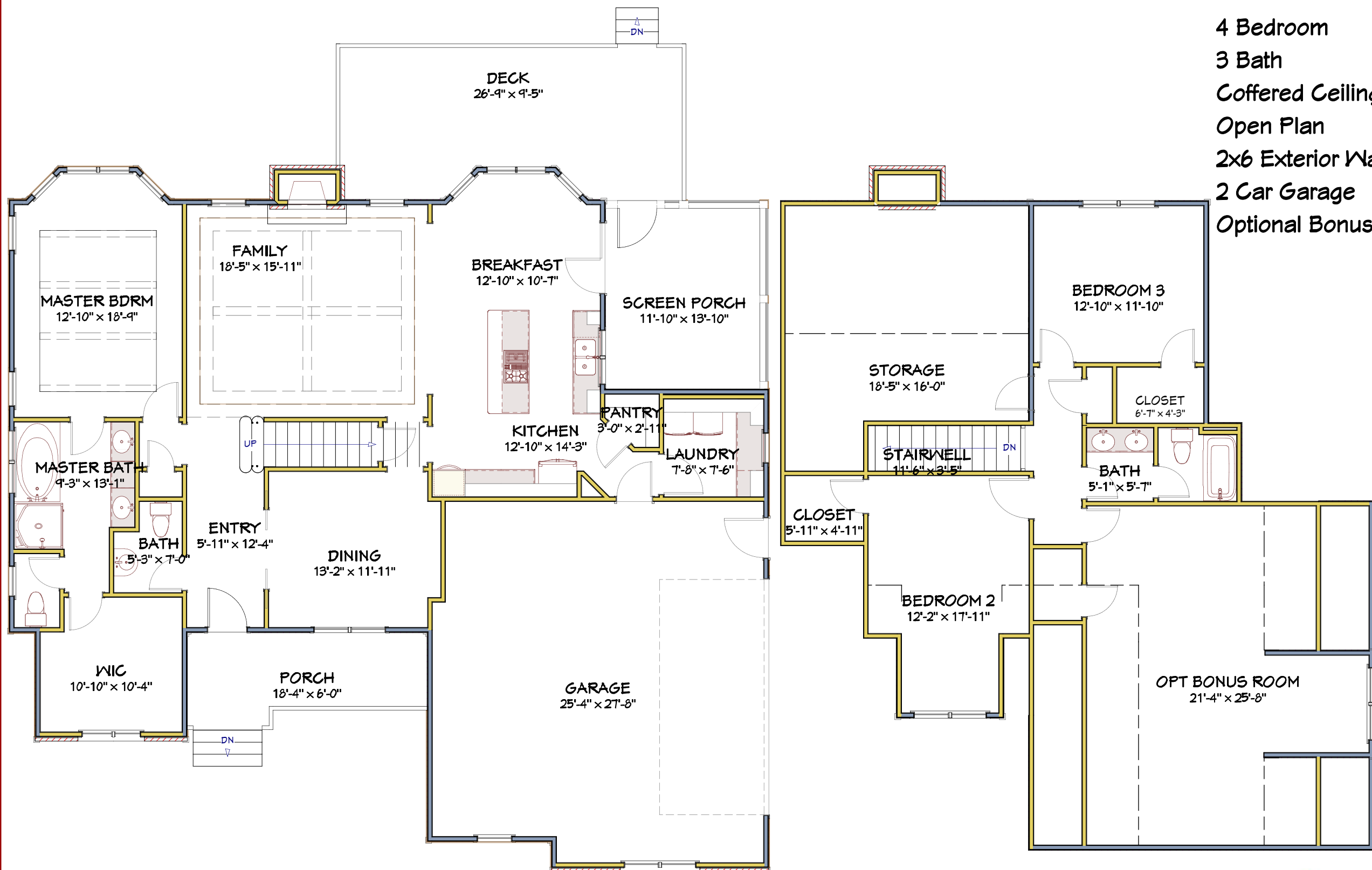

- 4 Bedroom
- 3 Bath
- Coffered Ceilings
- Open Plan
- 2x6 Exterior Walls
- 2 Car Garage
- Optional Bonus Room 489 sqft

58' Wide by 53'-6" Deep
2311 Total Square Footage



CUSTOM HOMES

252.637.9770

scheperhomes@coastalnet.com

3962 MLK JR BLYD. NEW BERN, NC 28562 * www.scheperandassociates.com